

Welcome To The Barn

78a Arawa Street, Ohakune

Directions:

From Wellington, after the BIG CARROT which is on your left, take first turn to the right (Arawa Street). Drive towards end of road, we're the fourth house from the end on the right hand side. There are two houses on the section, ours is the front one which looks a Barn. Don't leave your car on the driveway as the people in the back section need to be able to get their cars out. You can park alongside the driveway, next to the house and the kitchen area or out the front. When leaving your car, check you have nothing 'tempting' in view, just in case an opportunist passes by.

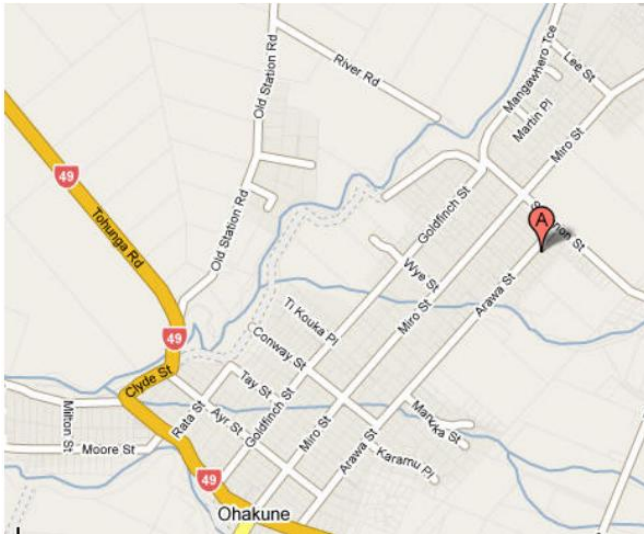

KEY:

When you arrive at The Barn, two keys are inside of the lock safe which is inside the power box by the front door.

1. You have to reset the safe by pushing down on the bottom lever
2. Enter code which will be emailed to you when you made the booking
3. Push down the top lever which opens key safe
4. Remove front of lock safe to remove keys
5. You have to enter the code the same way to put the front of the lock safe back on
6. Return keys once you have cleaned and are leaving The Barn

If you can't get the lock safe open or the keys are not there you can call Vivienne or Geoff Pittman on 06 3859594 or 021 484 157 and they can bring another key to open The Barn. Please note if you can't open the key safe because of user error your group will be charged a \$50 call out fee.

The key fits in the ranch slider door at the front. You need to lock it with the key when leaving the house, and at night. The back door is usable from the inside only – for getting wood in, and for bringing snowboards/skis and wet gear in. Keep that door locked all the time. As a double lock, push the door handle in and to the right and push the top bolt lock up. Please return keys to the key safe once you have cleaned up the house. Please note there is a \$50 lost key charge if you lose a key.

Please do not touch any of the fuses in the power box unless a fuse is blown and requires resetting.

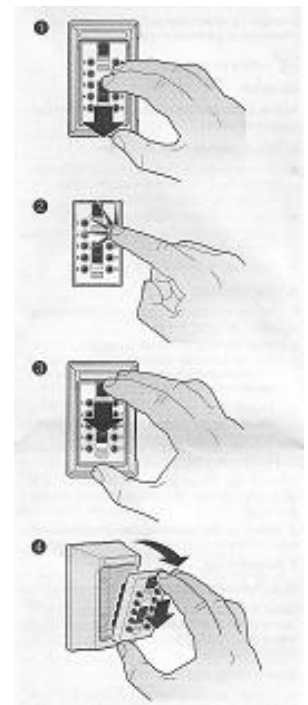

TAKE:

Sheets, pillowcases, towel, food, toilet paper, matches, newspaper, kindling, torch, and sleeping bags/duvet (there are lightweight duvets and pillows however these are only meant to be slept on). Please do not move the beds or the provided light weight duvets around.

CHECK IN/OUT TIMES:

Please ensure you have cleaned and checked out by 10am.
You can check in anytime after 2pm.

HOTWATER:

When you arrive go into the drying room and turn the hot water on, when you leave please go in and turn it off again. There is a wetback on the fire too so if you want to reheat water fast then have the fire going.

FIREPLACE:

Key is hanging on the fridge for the wood shed, which is out the back door. Please return the key to the hook after use. Get fire going as soon as you arrive to warm the house up. **To operate:** before opening the door, gently pull right hand lever straight out, move left knob to left. Put kindling (it pays to bring your own kindling) and paper etc in and light. Keep left knob open to the left and once going well move half way or over to the right if you want to close it down. Push right hand lever in once the fire is going. (Please leave a stack of firewood and chopped kindling for the next group. A chopping stump is out the back near the wood shed, the axe is chained up and attached to the shed. Please don't use the concrete walking slab or the fire hearth to chop wood. Lock door of shed afterwards and return the key to the fridge. Please don't burn cardboard or shiny paper as this blocks the chimney. If The Barn is getting low on dry firewood please let us know so we can order more.

BBQ/GAS BOTTLE:

There is a BBQ that you are welcome to use, the gas bottle is kept in the wood shed, if it is low on gas you may need to fill it up at the BP in town. Also after you finish using the BBQ please clean it.

CLEANING:

Please use the checklist below to complete cleaning The Barn. There are replacement vacuum bags and some cleaning products in the cupboard under the laundry sink. The vacuum is under the bed in the 1st room and the mop is in the drying room. Take rubbish to the transfer station on Old Station Rd (see map below), please note they only take cash. There is an optional cleaning service available for \$120 if you would prefer not to clean the Barn yourself. Please advise you require this and pay for this service before your stay. This does not include doing dishes, please clean these before you go otherwise cleaning costs will be taken out of your deposit.

- Vacuum Whole House
- Clean Toilet
- Clean Shower and Bathroom
- Clean Kitchen
- Replenish wood supply (please advise us if the dry firewood is getting low)
- Take rubbish and recycling to the tip (the A marked on the map below is where the tip is)
- Tidy up all beds and bedding

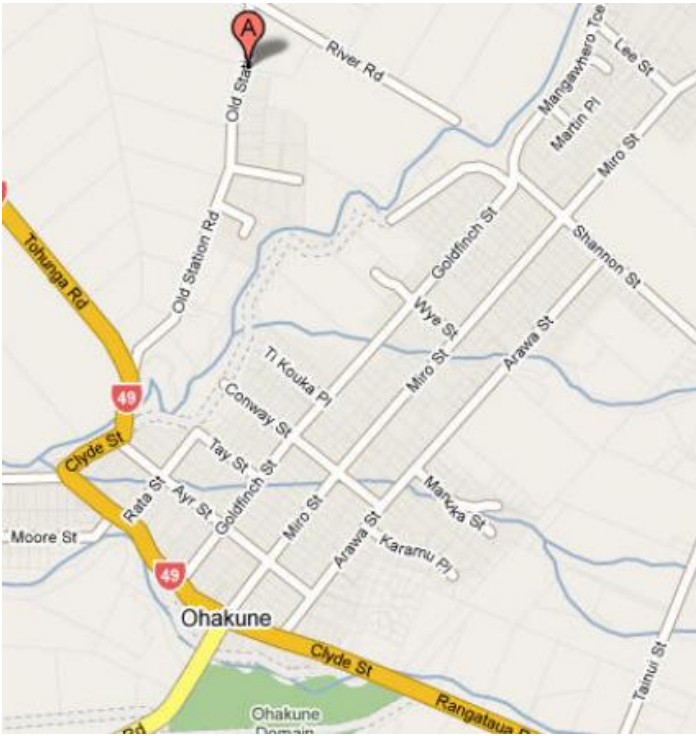

LAUNDRY:

If you need to do laundry there is a Laundromat by the dairy next to the BP on Clyde St.

SMOKING:

Outside only.

SHOES:

Please remove muddy shoes/boots before coming in the house.

CONSIDERATION:

Though you are welcome to have friends to visit we do not allow parties at The Barn, the reason being is that parties tend to disturb neighbours and things can get broken, there are plenty of bars in Ohakune where you can party. Please note that there can only be a limit of 20 people staying overnight. We also understand that sometimes things do get broken, if that happen we would appreciate that you let us know and then kindly fix or replace the broken item.

CONTACTS:

Please phone if you have a problem:

Dan and Becs	09 300 7332
Beccs	027 4222 164
Dan	027 289 1353

ENJOY YOUR STAY -THANKS FOR YOUR HELP AND CONSIDERATION.